

LED strips for DF & MAX version displays

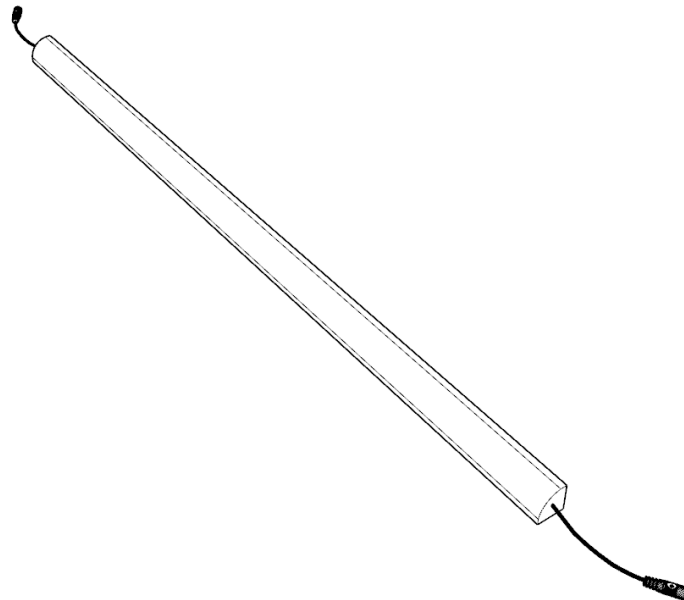

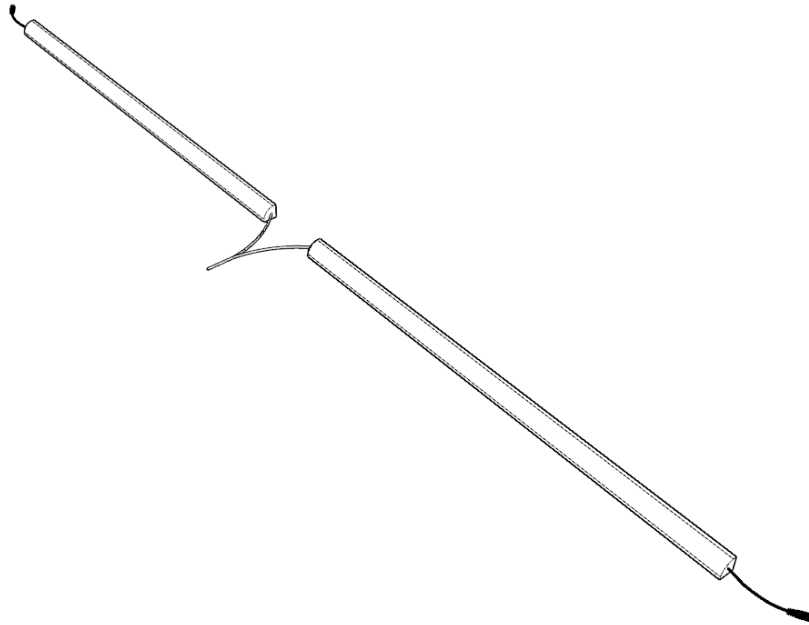

Content included

- LED strips
 - Double strips for MAX140, DF120
 - Single strip for DF30, DF60, DF130, MAX70, MAX150
- Single LED strip 1 Amp power supply
- 3m extension wire cable
- Cable conduit

Optional purchase:

LED strips expansion pack

- 10Amp power supply brick
- 1 to 3-way split cable

Remove display's base

Tear of double-sided tape and paste the LED strips to the top panel

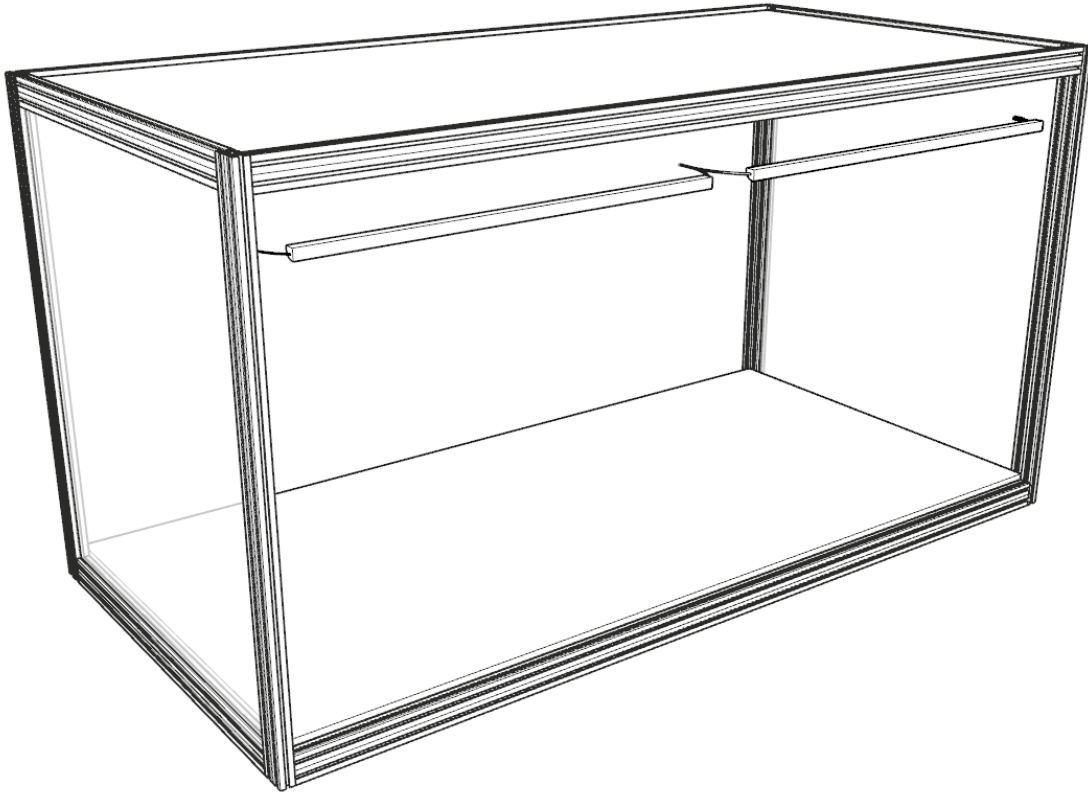

Paste cable conduit at top right corner of display

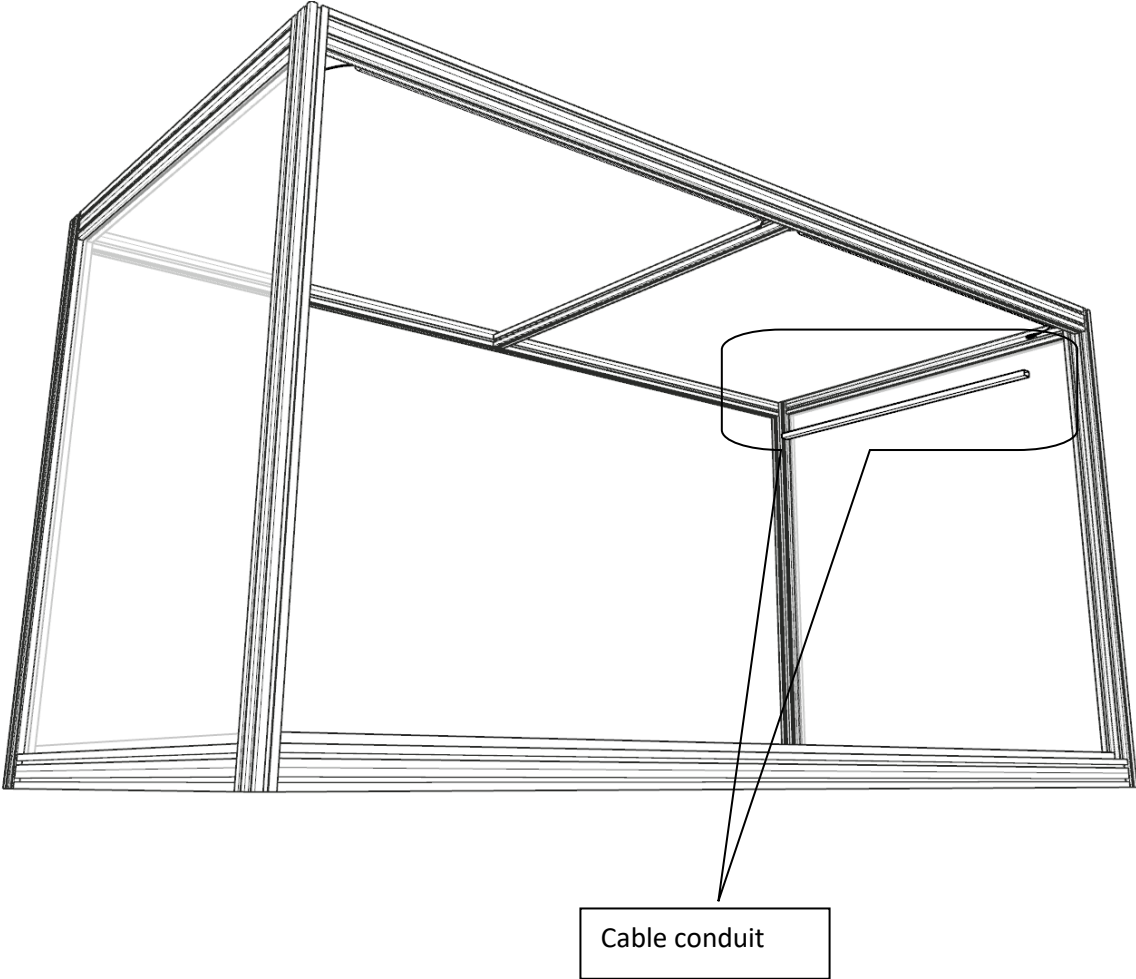

Connect the 3m extension cable to the LED strip

Align the wires inside the conduit and along the back frame (Orange colour).

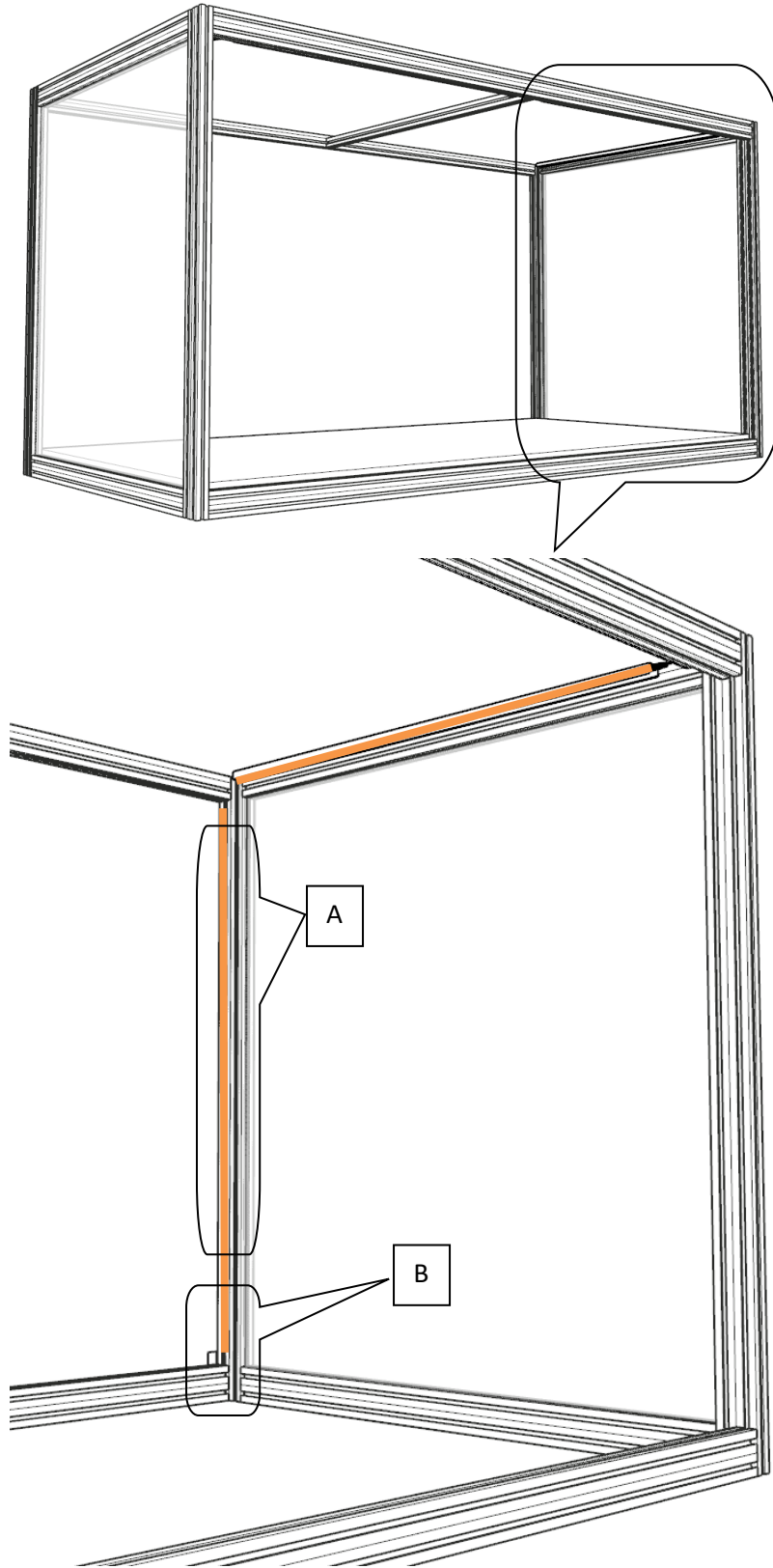

A - Insert wires into aluminium slots and place rubber wire holder in

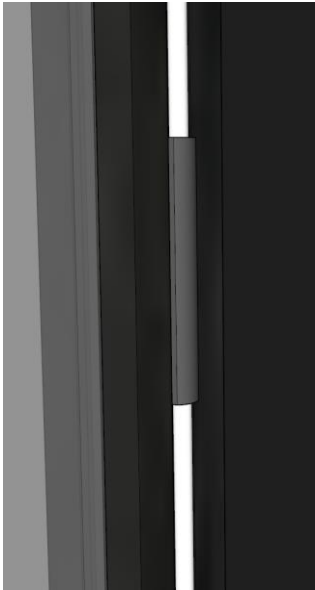
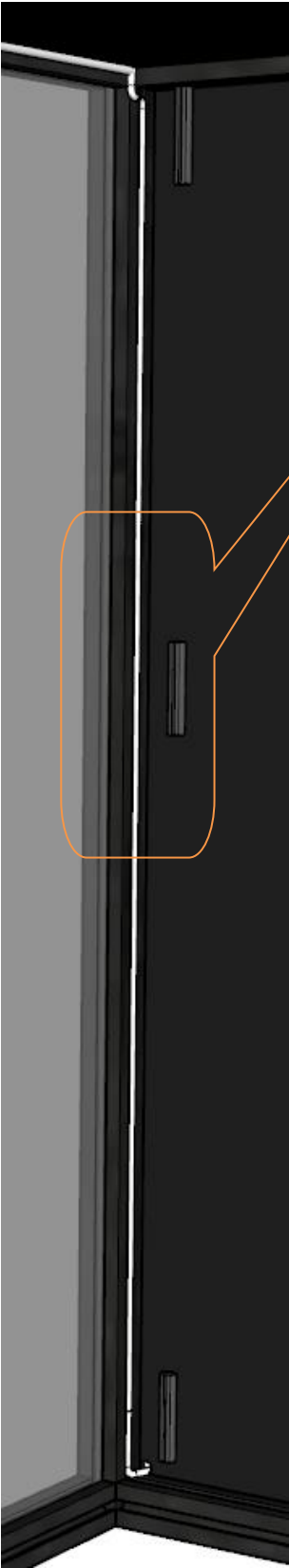

*Note

Wire holders are attached to the back frame

B - Insert wires into the hole at the bottom left/right of the back panel



