

**MODU
SPACE**

Bespoke Showcase Engineers

DF120 Assembly Guide

Version 3.0

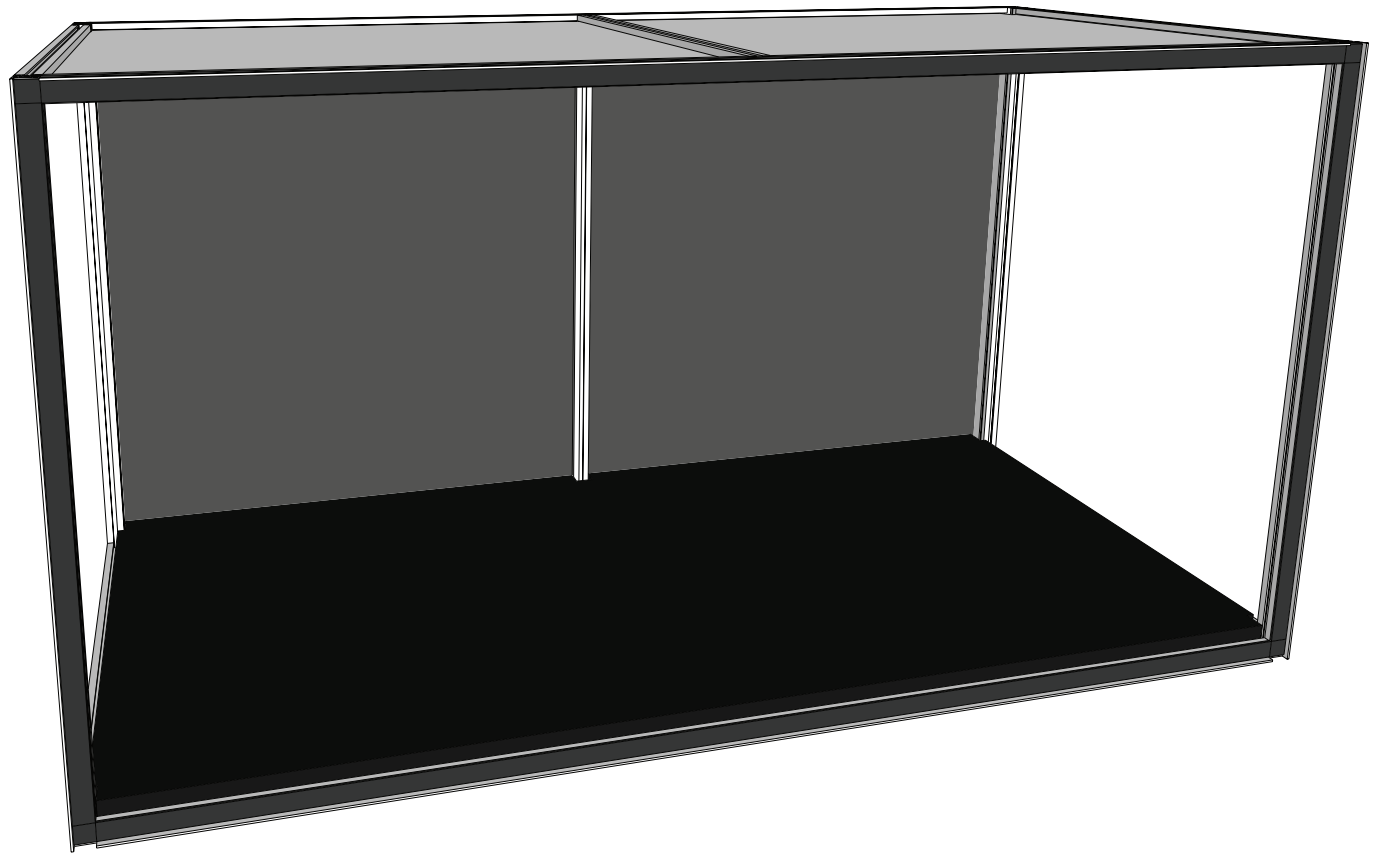

Back Frame
Middle Vertical Bar



Back Frame
Vertical Bar x 2

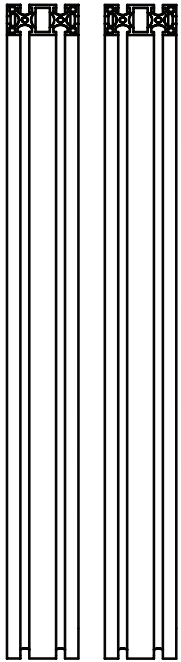

Back Frame
Horizontal Bar x 2

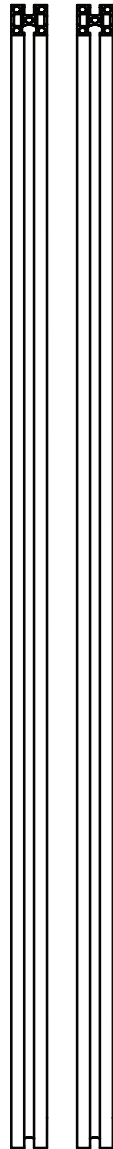

Front Frame
Horizontal Bar x2

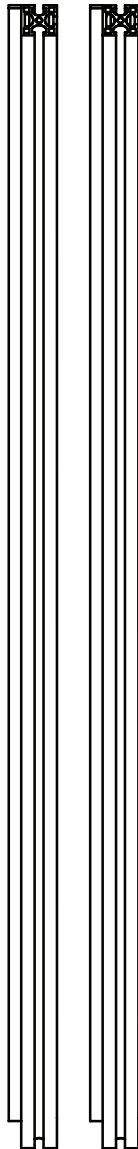

Front Frame
Vertical Bar x 2

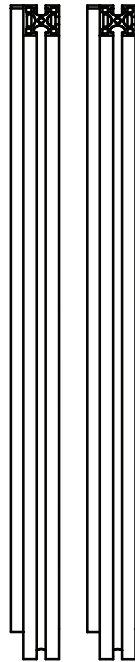

Side Frame
Horizontal Bar x 4

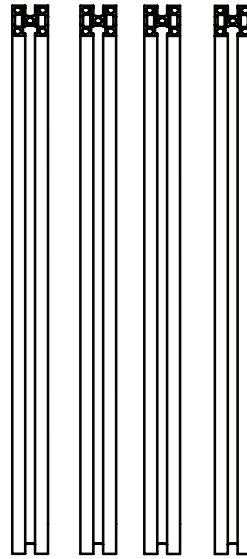

Middle
Horizontal Bar x 2

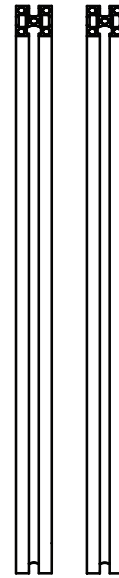

Vertical
C-Channel x 4



Horizontal
C-Channel x 4



Conduits x 2



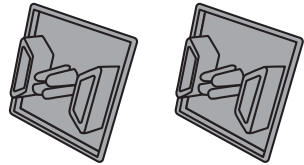

Front Frame Foot Pad x 2

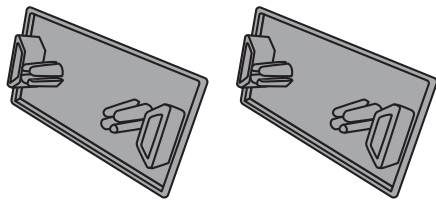

Back Frame Foot Pad x 2



M5-Long Screw x 22



M5 Washer x 22



M4 Allen Key x 1



Front Panel Safety Screw x 1

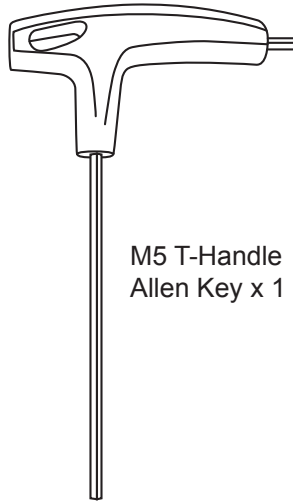

M5 T-Handle Allen Key x 1

Accessories for connecting display cases

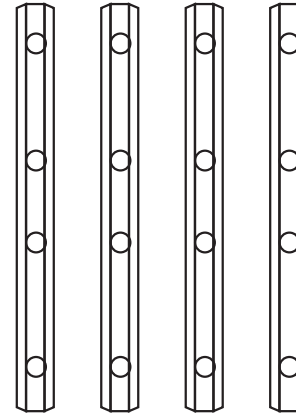

Stacking Bracket x 4

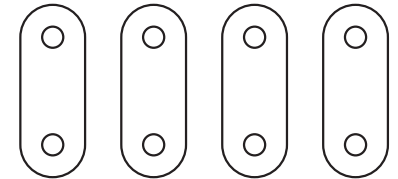

Horizontal Bracket x 4



M5 Nuts x 8



M4 Stacking Screw x 8



M5-Short Screw x 8



Attention: If you are connecting multiple display cases, please refer to "Connecting Display Cases" assembly guide before commencing.

Plexiglass Side Panel x 2

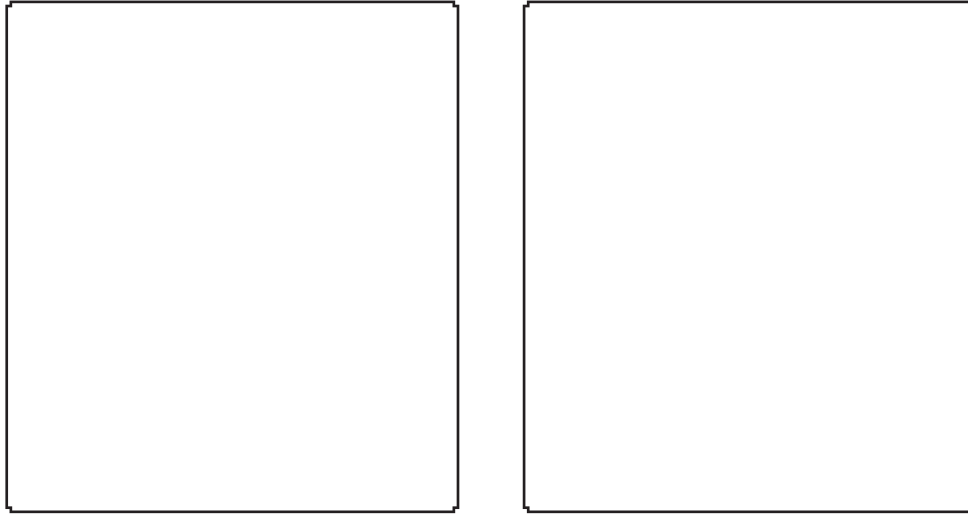

Plexiglass Front Panel x 1

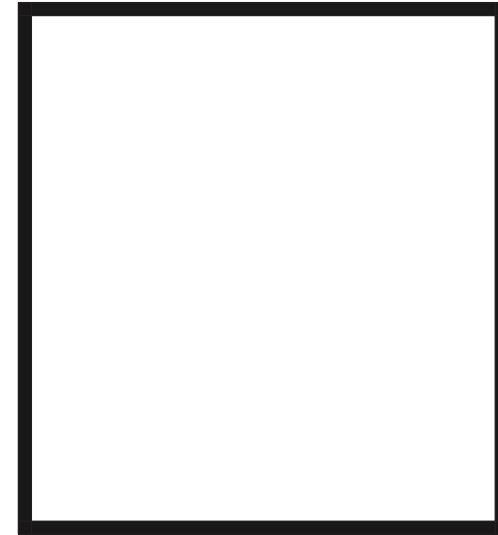

Back Panel x 2



Top Panel x 2



Laminate Base x 1

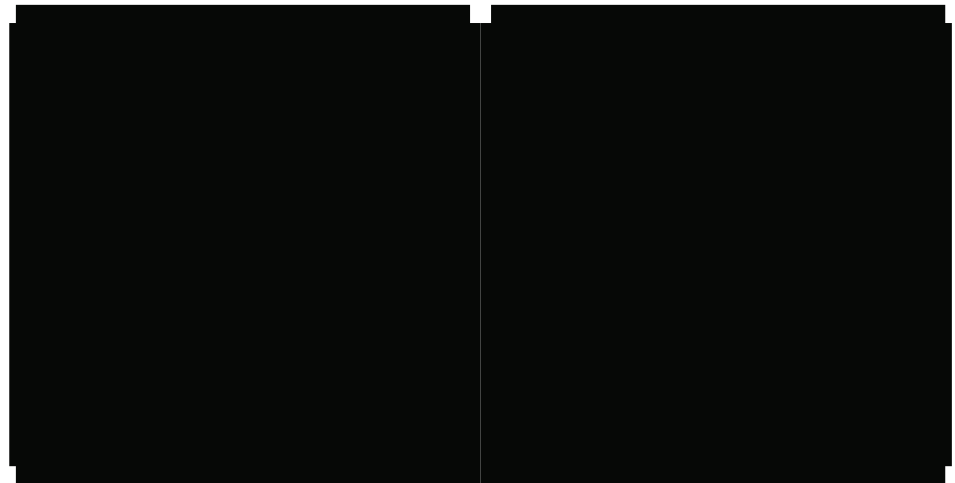

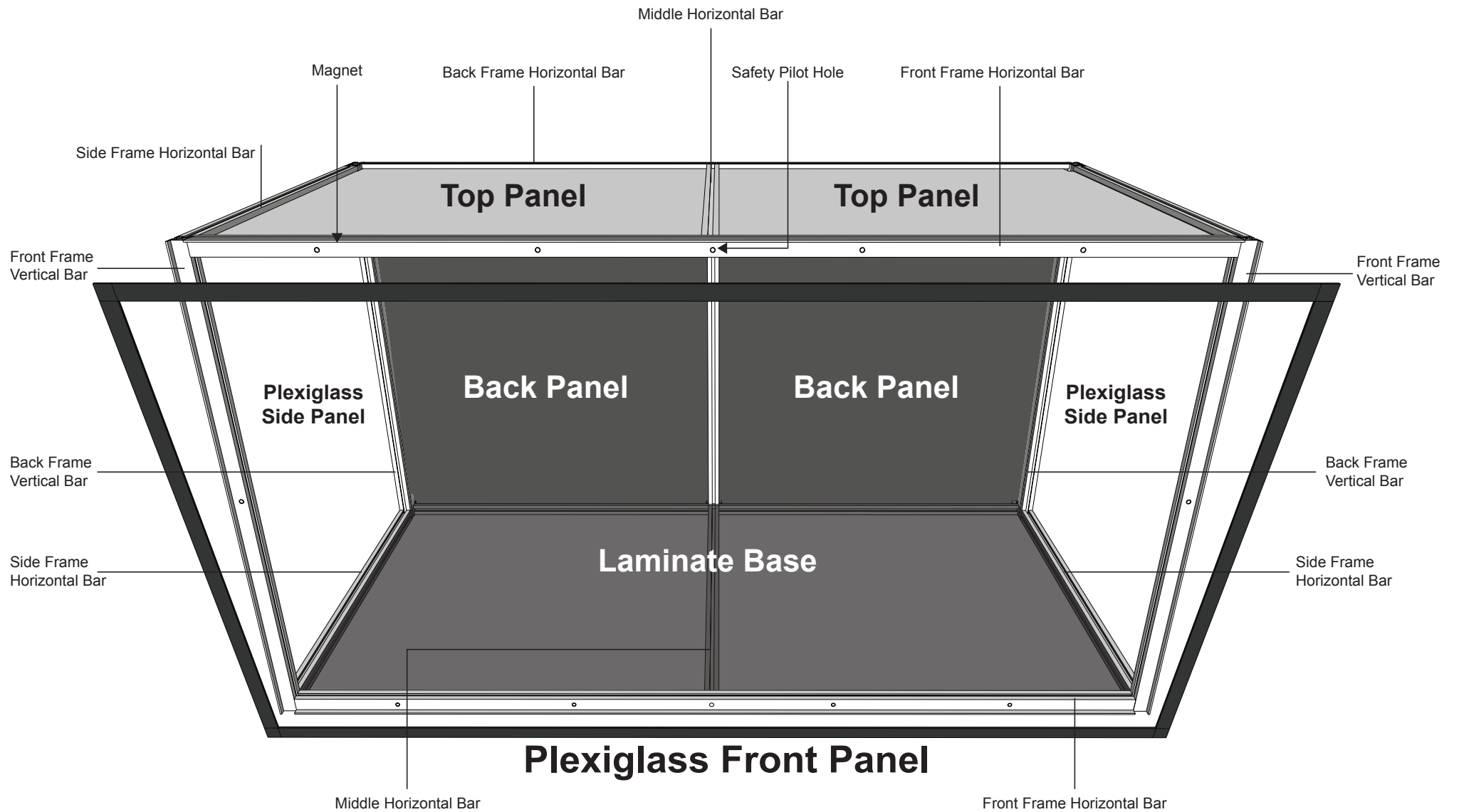

You will need

- Side Frame Horizontal Bar x 4
- Back Frame Vertical Bar x 2
- Front Frame Vertical Bar x 2
- Horizontal C-Channel x 4
- Vertical C-Channel x 4

Steps to install C-Channel

Step 1. Flatten one end of the C-Channel by pressing the open edges together.

Step 2. Push the compressed tip into the slit of the bar.

Step 3. Press down the rest of the C-Channel

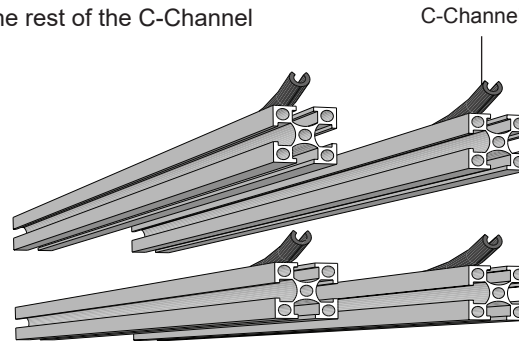

Side Frame Horizontal Bar

Position the bar on any side. Install a Horizontal C-Channel into the top slit of the bar. Repeat for all bars.

Back Frame Vertical Bar

Position the bar with the pilot holes facing the flat surface. Install a Vertical C-Channel into the top slit of the bar. Repeat for all bars.

⚠ Please make sure the C-channel does not cover the pilot hole.

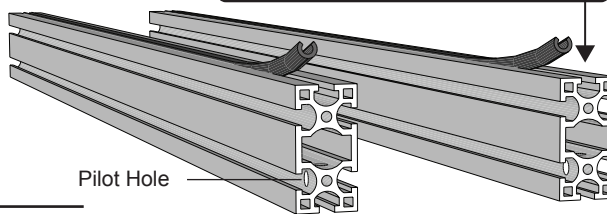

⚠ If you are joining the display cases horizontally, do not insert the C-Channel on the connecting bar.

Front Frame Vertical Bar

Place a bar with the magnets facing down. Install a Vertical C-Channel into the top slit. Repeat for all bars.

⚠ Please make sure the C-channel does not cover the pilot hole.

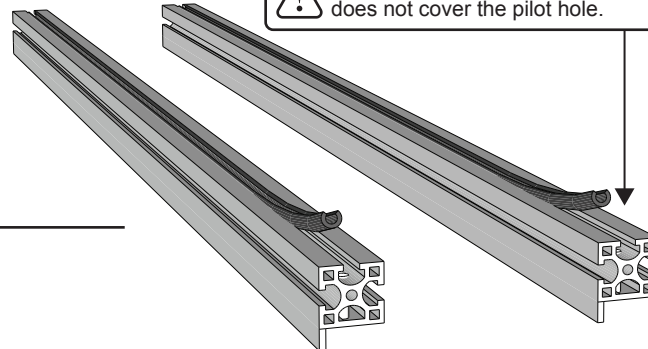

⚠ If you are joining the display cases horizontally, do not insert the C-Channel on the connecting bar.

You will need

- M5-Long Screw x 22
- M5-Washer x 22
- Side Frame Horizontal Bar x 4
- Middle Horizontal Bar x 2
- Back Frame Middle Vertical Bar x 1
- Back Frame Horizontal Bar x 2
- Front Frame Horizontal Bar x 2

Steps to insert M5-Long Screw

Step 1. Insert the M5-Long Screw fully into the M5-Washer.

Step 2. Position the screw with washer into the pilot hole on the left side of the bar. Turn clockwise to tighten the screw. Leave a 15mm gap between the washer and bar.

Step 3. Repeat steps 1-2 for the other side of the bar.

Step 4. Repeat steps 1-3 for

- Side Frame Horizontal Bar x 4
- Middle Horizontal Bar x 2
- Back Frame Middle Vertical Bar x 1
- Back Frame Horizontal Bar x 2
- Front Frame Horizontal Bar x 2

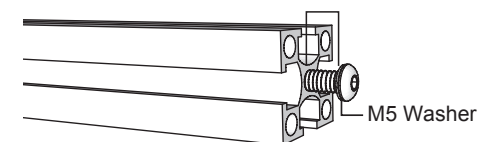
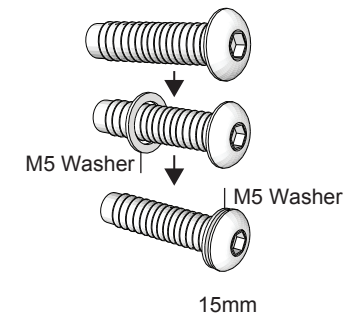

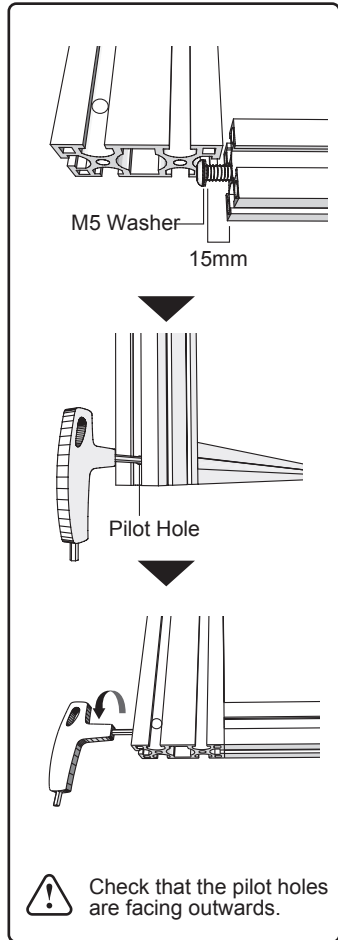

Step 1.
Connect Back Frame Vertical Bar to Side Frame Horizontal Bar. Tighten the connecting screw using the T-Allen Key.

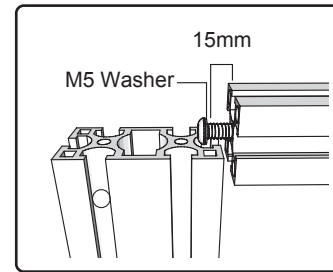
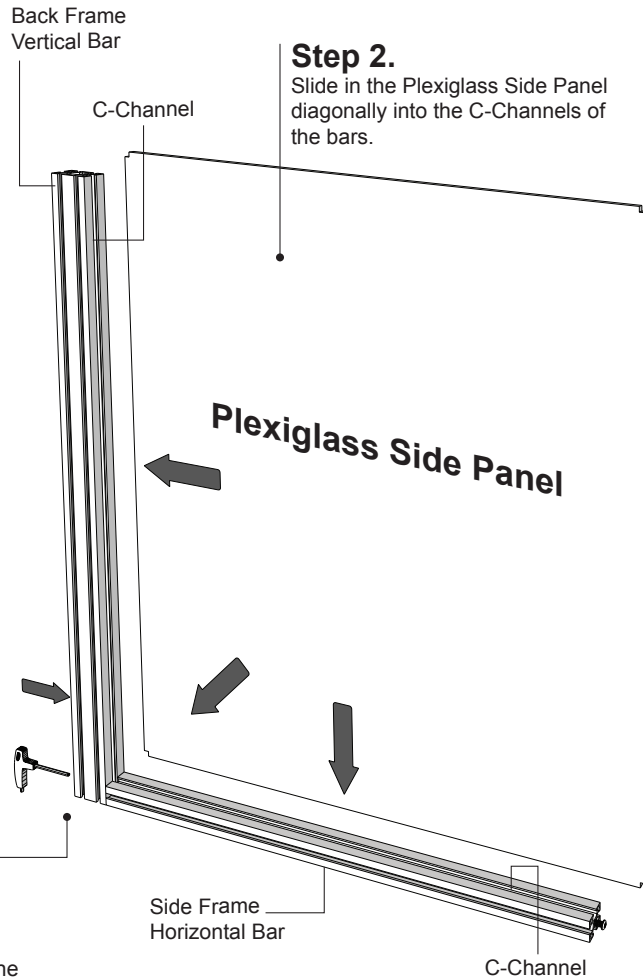

Step 4.
Press down the Side Frame Horizontal Bar into the Plexiglass Side Panel. Tighten the connecting screw using the T-Allen Key.

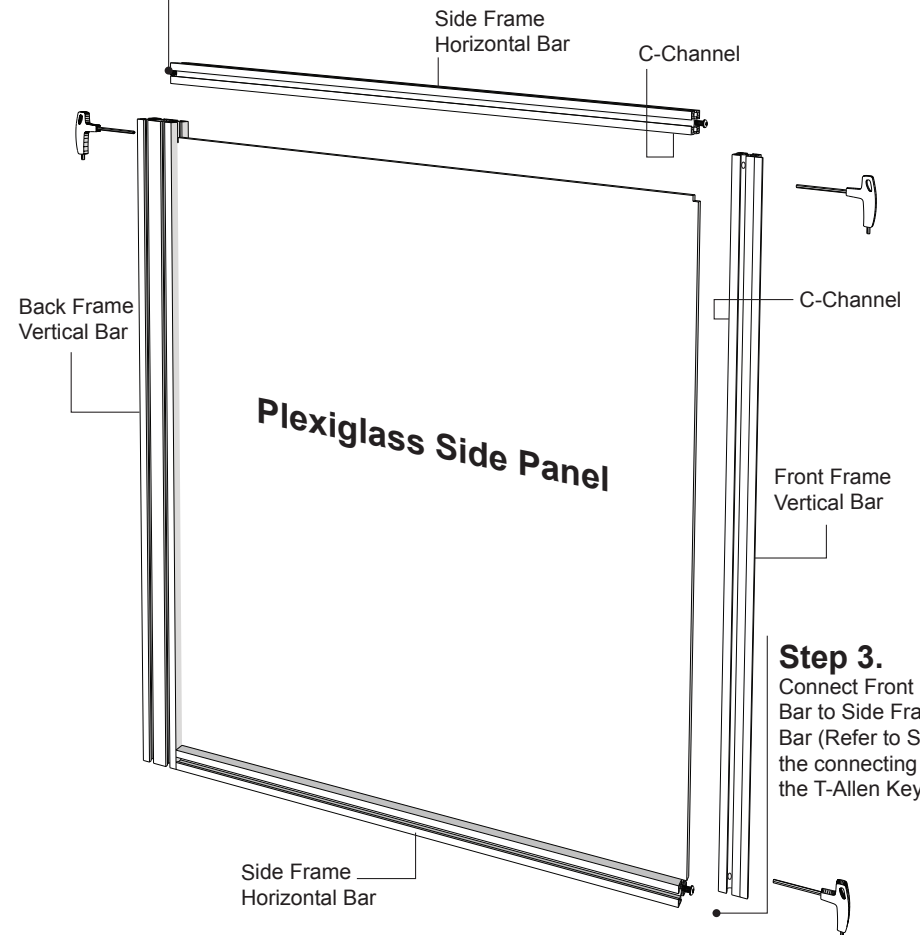

Step 3.
Connect Front Frame Vertical Bar to Side Frame Horizontal Bar (Refer to Step 1). Tighten the connecting screw using the T-Allen Key.

Step 6.

Slide in the Plexiglass Side Panel diagonally into the C-Channels of the bars.

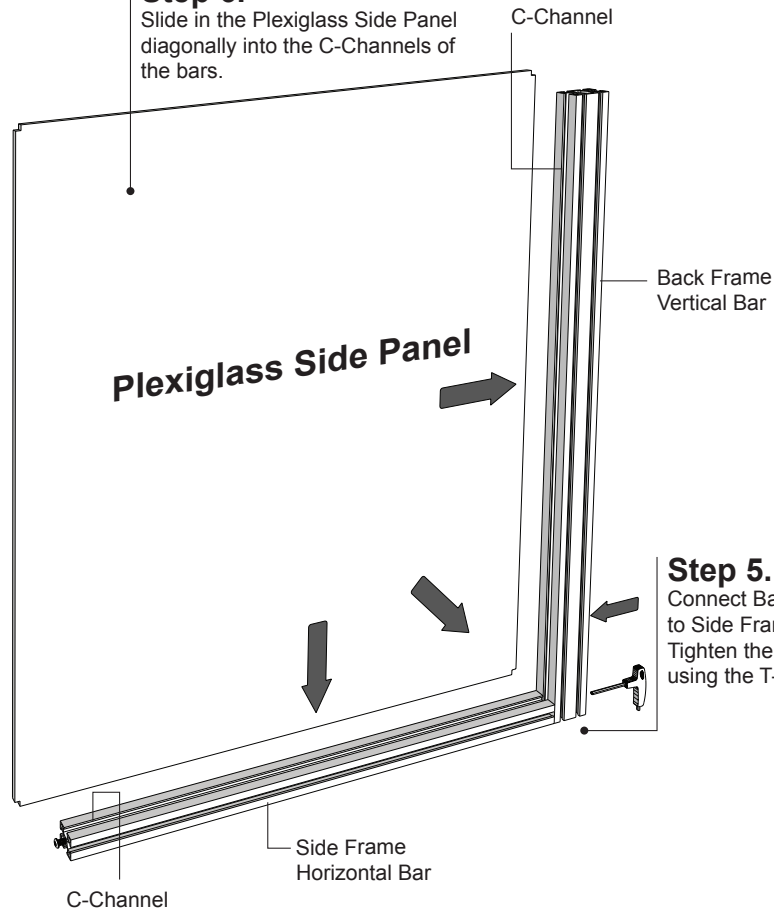

Step 5.

Connect Back Frame Vertical Bar to Side Frame Horizontal Bar. Tighten the connecting screw using the T-Allen Key.

Step 8.

Press down the Side Frame Horizontal Bar into the Plexiglass Side Panel. Tighten the connecting screw using the T-Allen Key.

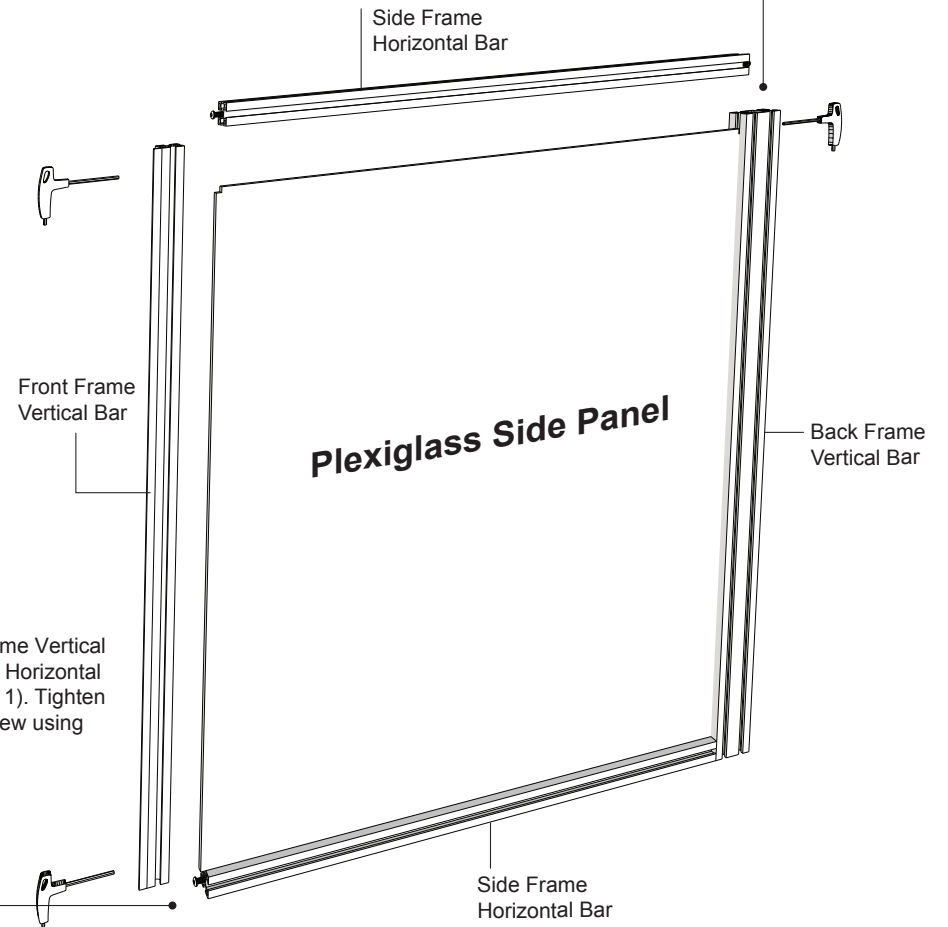
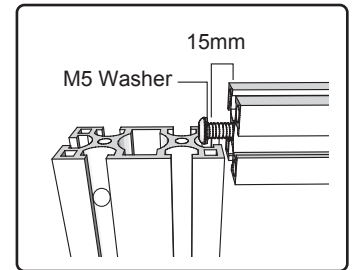

Step 7.

Connect Front Frame Vertical Bar to Side Frame Horizontal Bar (Refer to Step 1). Tighten the connecting screw using the T-Allen Key.

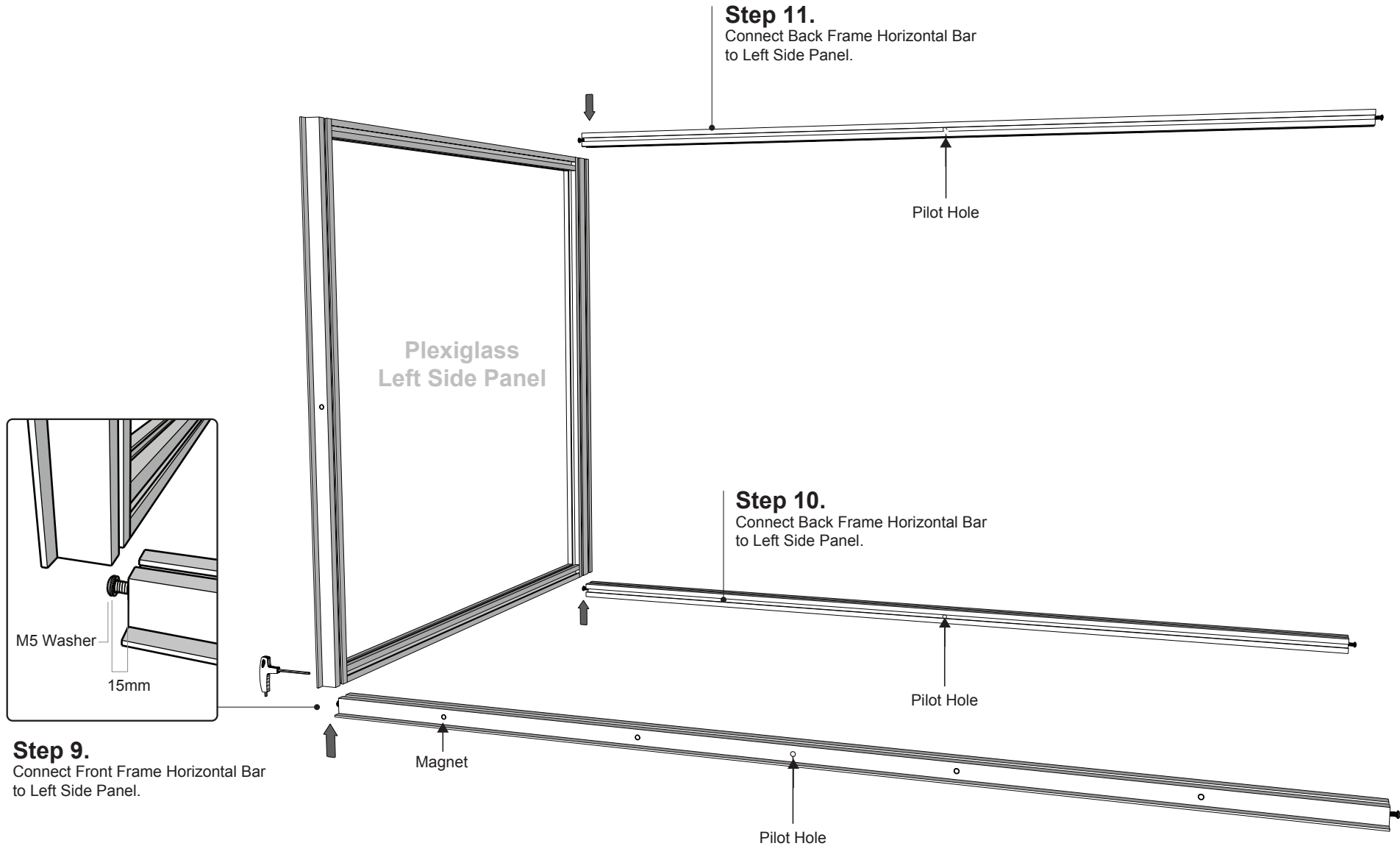

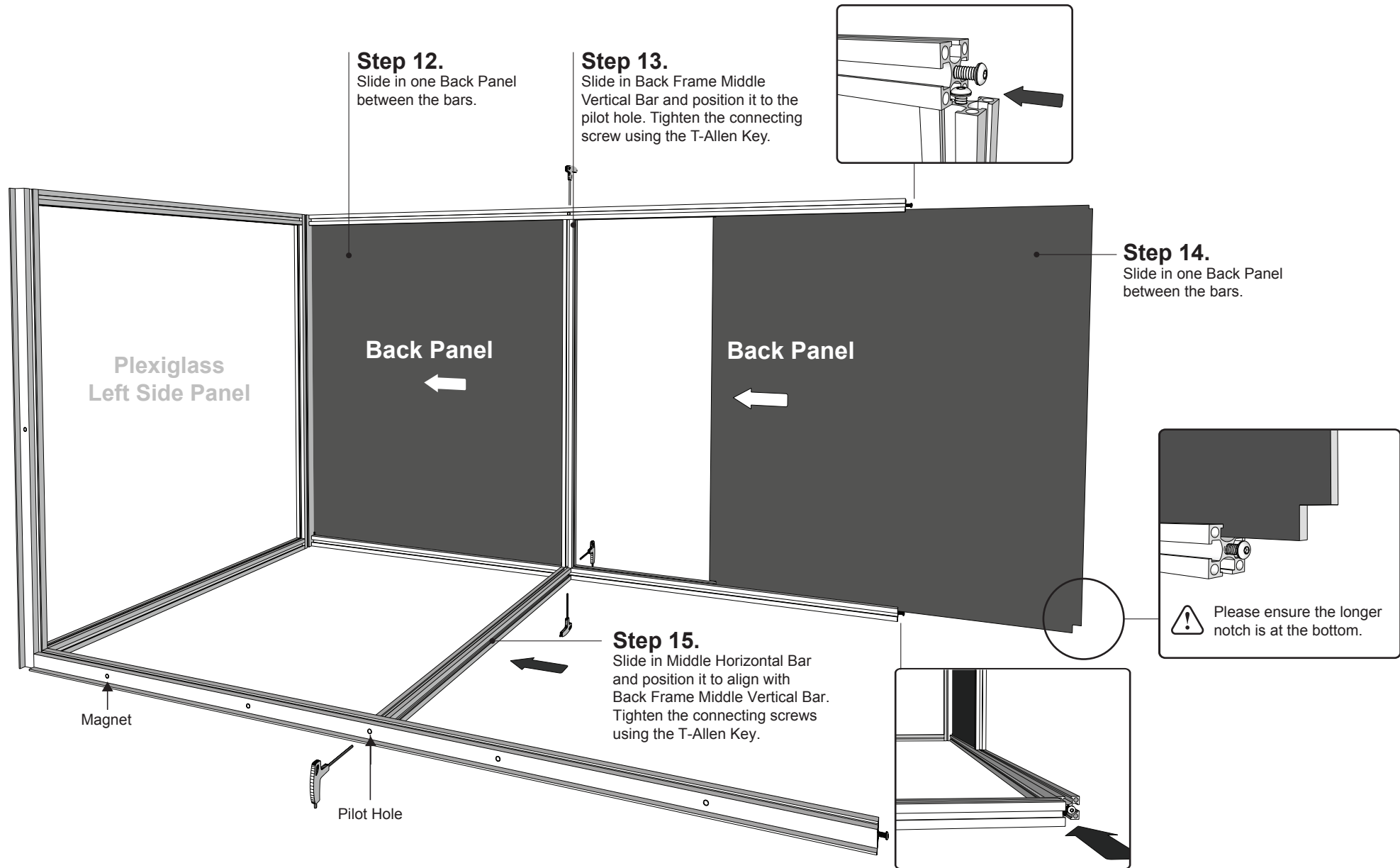

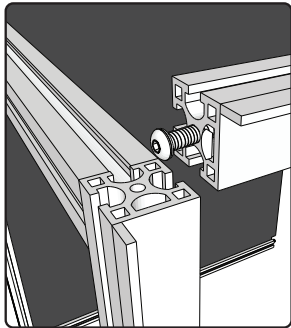

Step 16.
Connect Front Frame Horizontal Bar to Front Frame Vertical bar.

Step 17.
Slide in a Top Panel between the bars.

Step 18.
Slide in a Middle Horizontal Bar between the bars and position it to align with Back Frame Middle Vertical Bar.

Step 19.
Slide in a Top Panel between the bars.

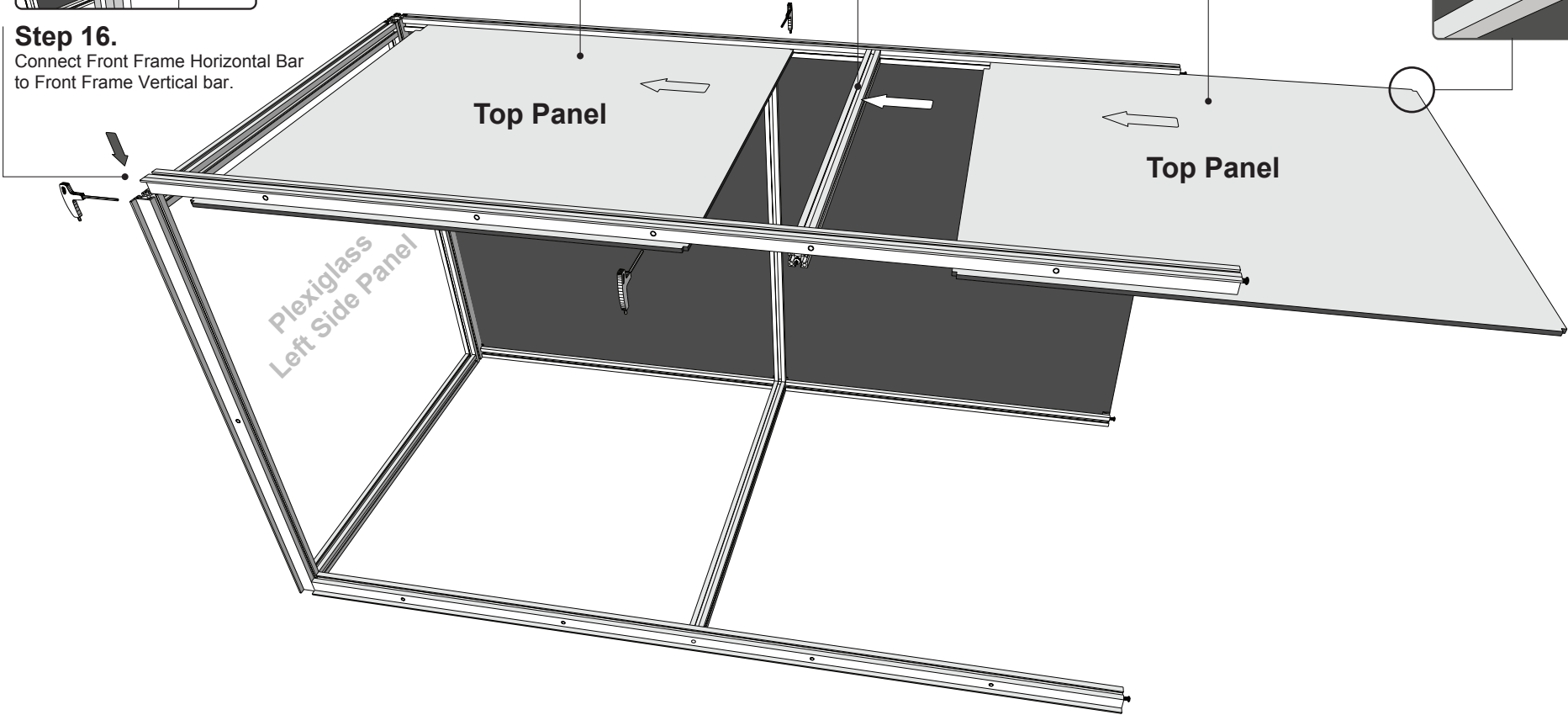
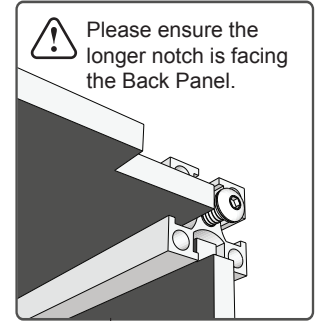

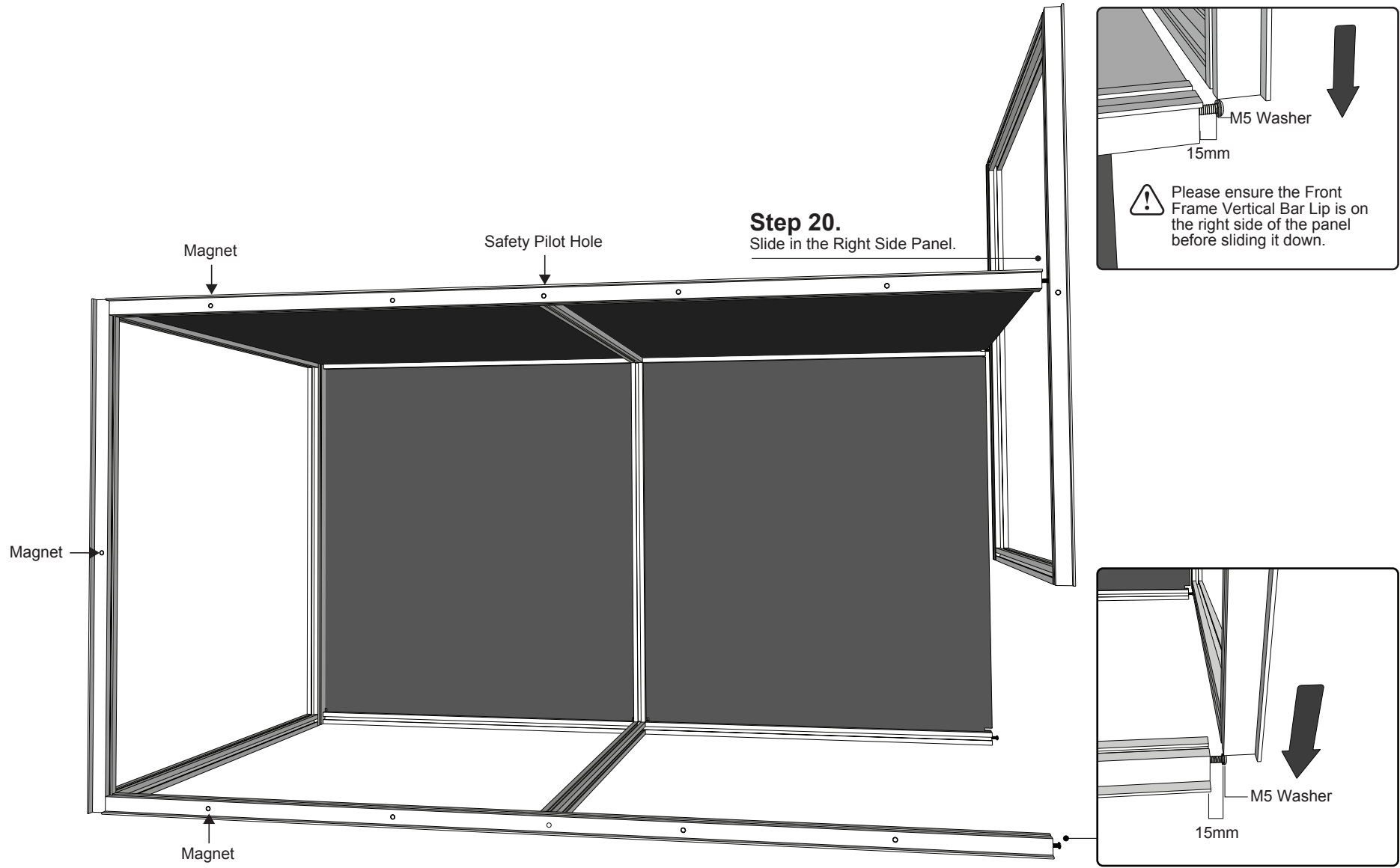

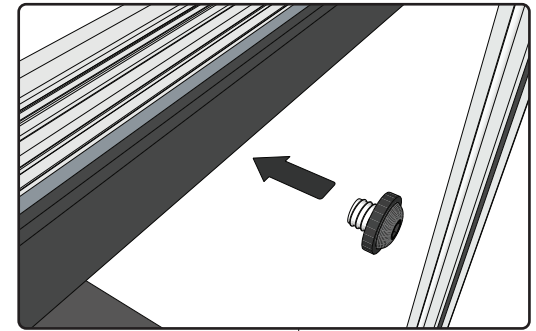
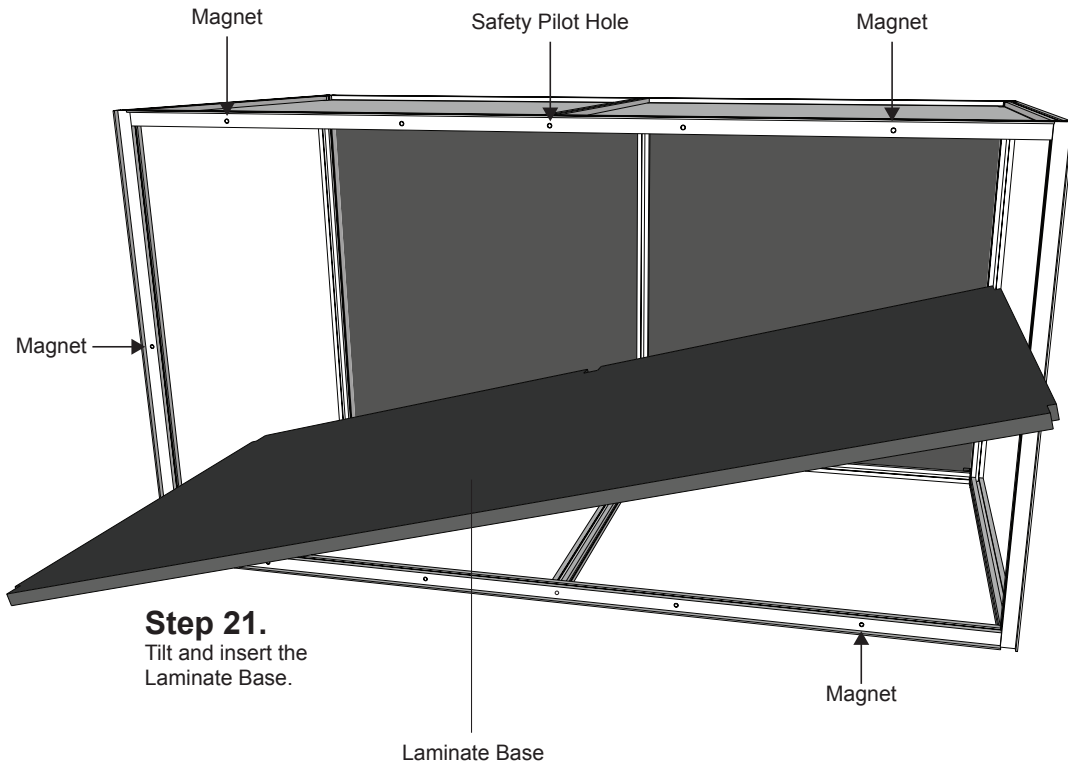

Step 22.
Attach the Plexiglass Front Panel and insert the Safety Screw.

